

Booster Sets

CAT5/CAB Washdown Booster Set

The Palmer UK CAT 5 Washdown Booster Set is designed to prevent backflow contamination of the mains water supply, while maintaining flow and pressure. The unit is compact, lightweight, and housed in a stainless steel cabinet for easy wall mounting.

Advantages

- Automatic operation
- Simple to wall or floor mount and install
- Easy access and maintenance

Design

Single diaphragm pump and water storage tank housed in a compact stainless steel cabinet.

1 outlet connection only

Applications

- Bin store washdown
- Limited boosting applications

Features

- Standard stock item
- Illuminated 'On/Off' switch
- Duty: 0.25 l/s @ 2.2 bar (mid curve)
- Lightweight stainless steel cabinet
- Break Tank: 18 litre (4 gallon)
- Glycerine filled pressure gauge
- CAT5 AB Air gap to prevent backflow contamination
- Optional Extra: Cabinet can be fitted with a thermostat controlled heater



Dimensions

Width: 420 mm
Depth: 370 mm
Height: 750 mm

Electrical

Watts: 0.37 kW
Volts: 240 V
Amps: 2.3 A

Approx Weight

25 kg

Please contact our sales team for further information on these and the complete range of water boosting equipment.

Requested data

1	Flow	l/s	
2	Head	m	
3	Geodetic head	m	

Pump

Operating flow	l/s		Frequency	Hz	50
Operating head	m		Number of poles		2
Impeller diameter designed	mm	60	Speed	rpm	2850

Test standard: ISO 9906:2012 - Grade3B

Water; 20°C; 998.3kg/m³; 1cSt

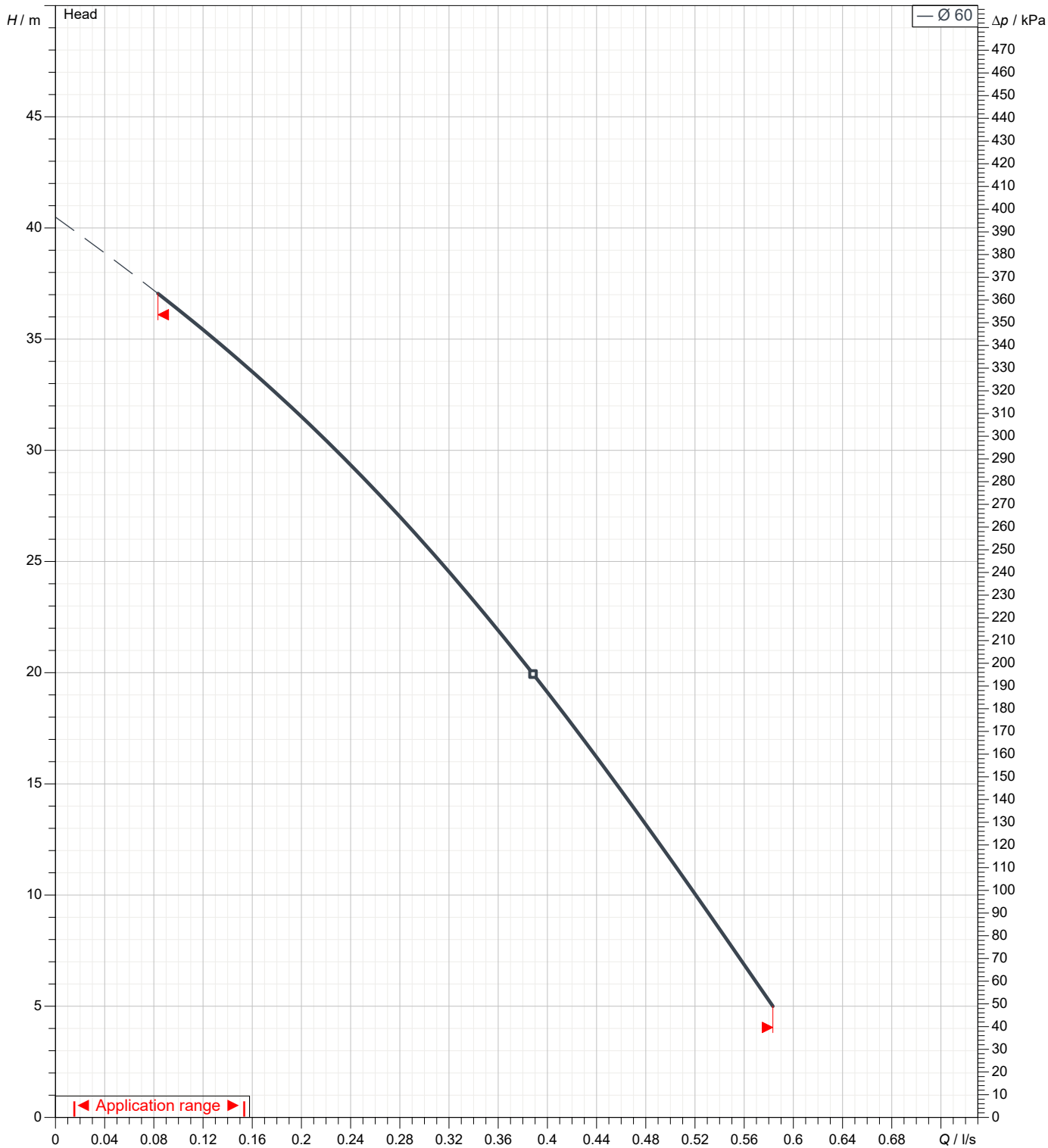

DO NOT SCALE - IF IN DOUBT ASK

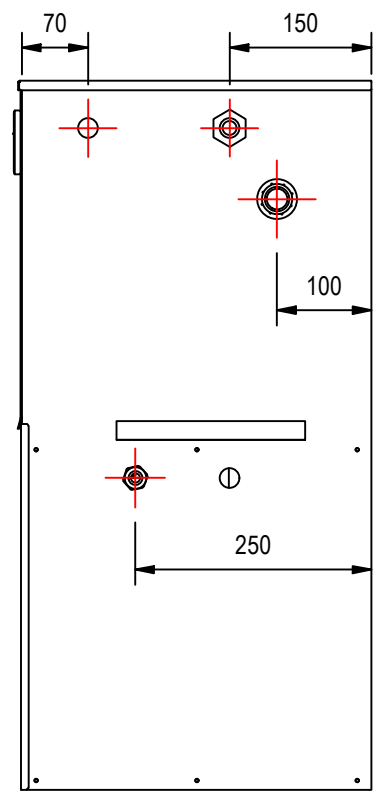
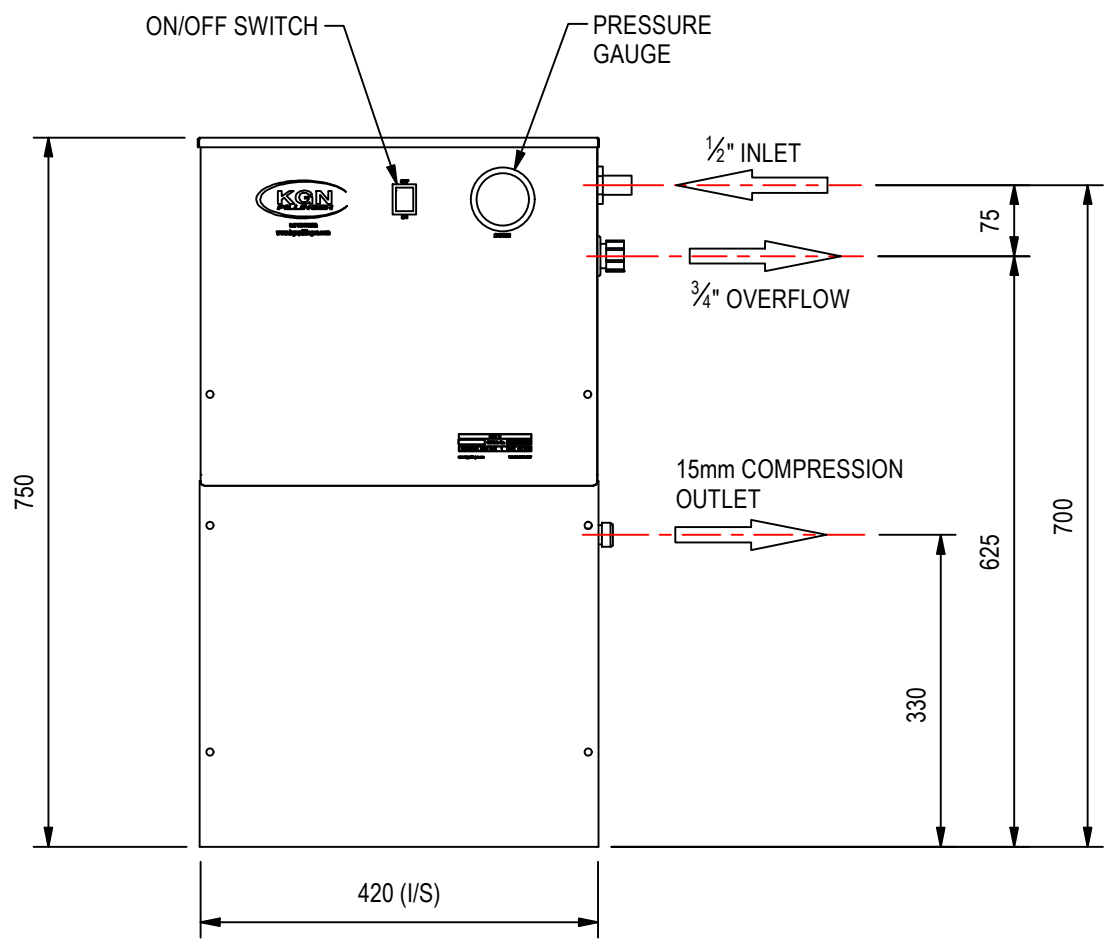
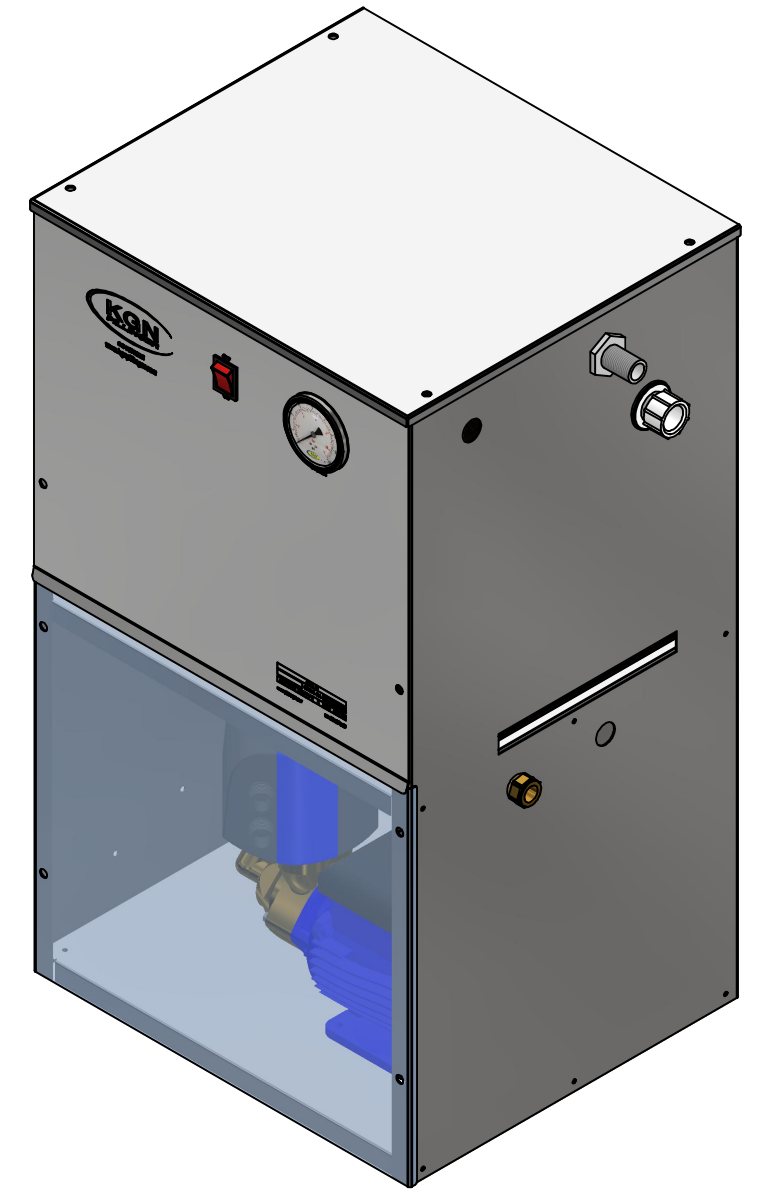
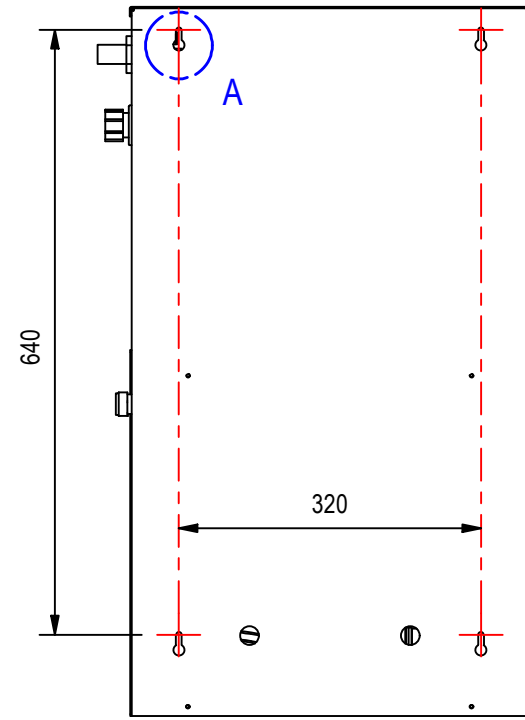
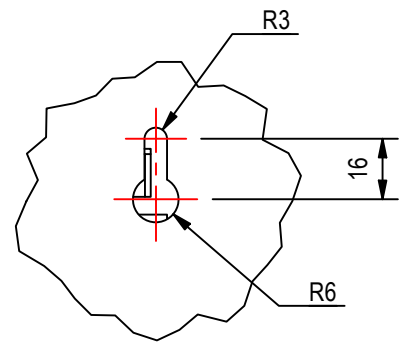
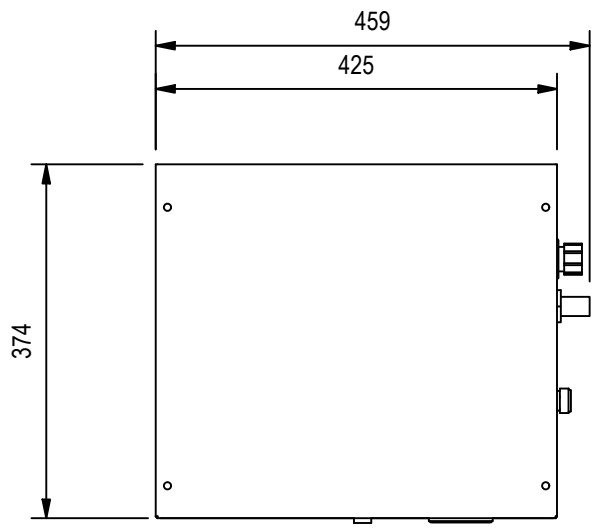

CAT5 BOOSTER UNIT FEATURES:-

- STANDARD STOCK ITEM
- LIGHT WEIGHT STAINLESS STEEL CABINET
- ILLUMINATED ON/OFF SWITCH
- DUTY 0.25 I/S @ 2.2 BAR
- LOW LEVEL PROTECTION
- BREAK TANK 18 ltr (4 GALLON)
- GLYCERINE FILLED PRESSURE GAUGE
- CAT5 AB AIRGAP